

Pokkrit (Poon) Jeerapat

Product Design & Art Portfolio

“Design for human  
health & thriving”

Grounded by Thai  
culture,

Inspired by Empathy,

Socially Oriented

Digital Manufacturing

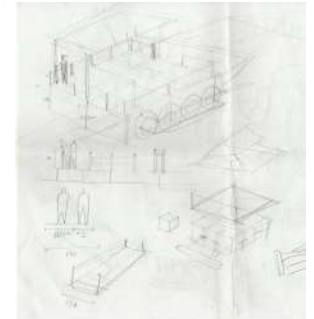
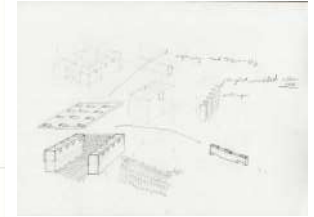
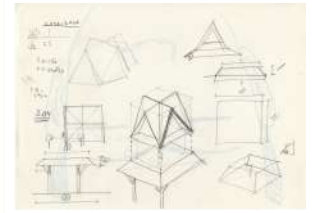
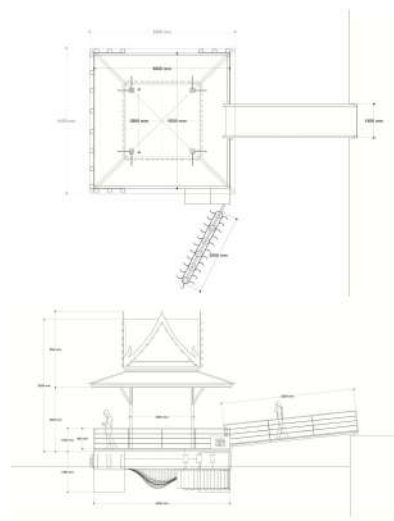
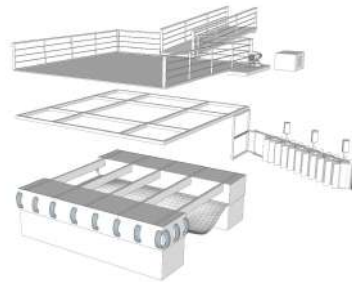
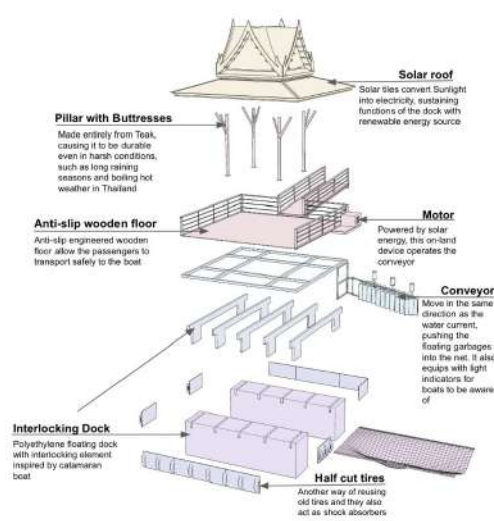
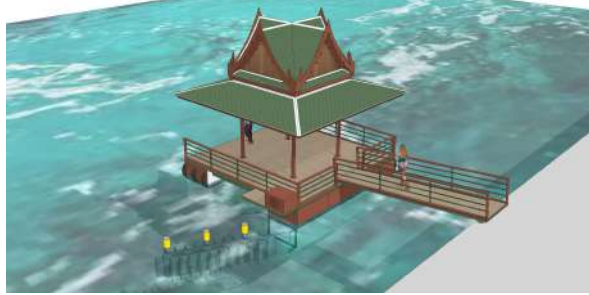

A design for a floating Thai Sala dock: I was inspired to design a new dock for public transport along the Chao Phraya River because the current one is uninspiring, drab and does not express any element of Thai culture. The dock is designed to clean the river with a solar-powered conveyor system that pushes the garbage into a net, which can be towed out by a boat.  
Created using SketchUp, Adobe Illustrator, and pencil - Independent project.

# Wiribed

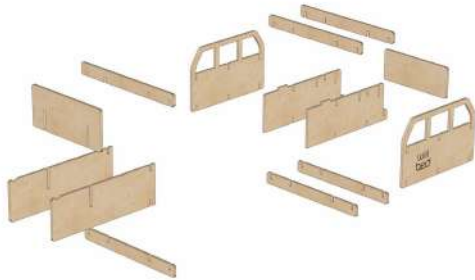
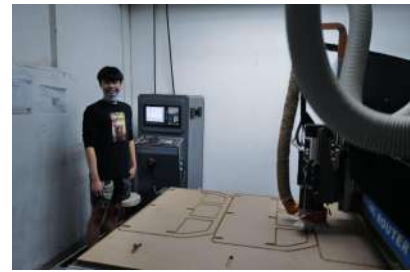
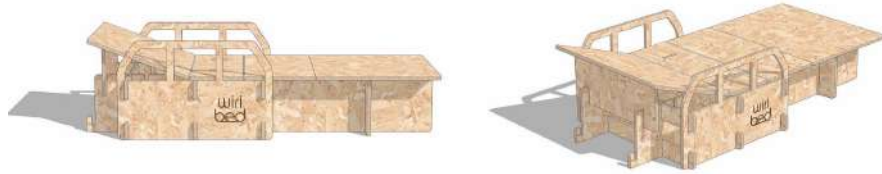

Page 07



Page 02



Page 05



Affordable interlocking hospital bed made from eco-friendly and durable material. The design is inspired by Japanese origami, the top piece is bendable to adjust to different positions. Weight distribution is integrated in the wooden legs, to support even the heaviest patients. It is a flat-pack. Created Using SketchUp in the design process and a CNC cutting machine, SolidWorks, and ArtCam to manufacture from MDF. 200 x 90 x 35 cm - Independent project.

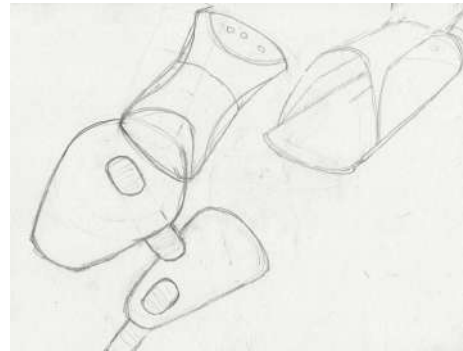
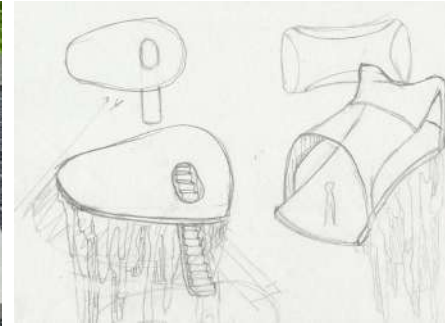
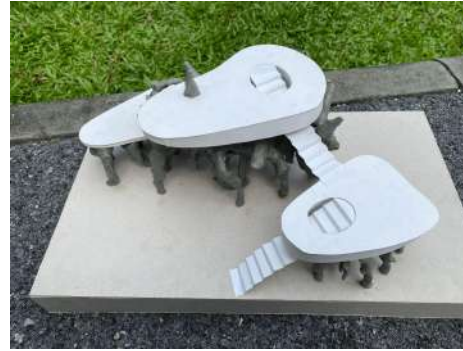

An architectural concept that imitates stalactites - expresses strength and endurance - since these geological formations accumulate over hundreds of years. To stand on a white flat platform above all the dark, mysterious, and scary stalactites conveys the emotion of being safe and serene. A concept for a public installation situated in nature that blends into its surroundings. 26 x 12 x 10 inches - Created using paper, clay, and pencil - Independent project.

# SpineX

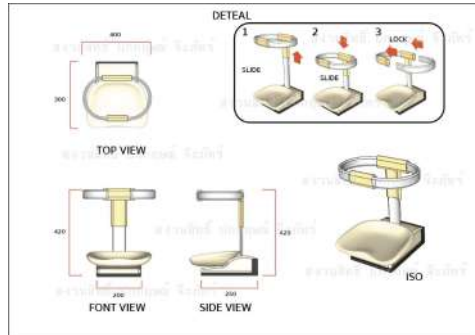
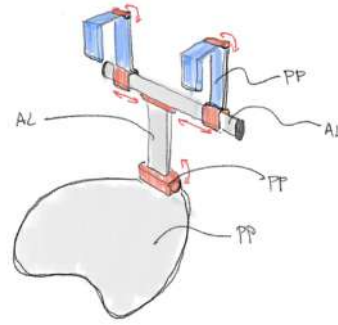
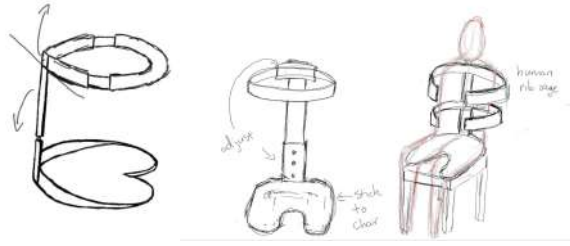

Accessory for a chair that serves the purpose of supporting the user's back, maintaining the right posture and spine alignment while remaining seated for a long period of time. This design was done for the Thailand Plastics Awards 2020 competition to create an innovative device from plastic. I ended up winning the prize (screenshot from evaluation call with judges).

37.1 x 38 x 42.6cm - Created using SolidWorks and resin-based SLA 3D Print - Independent project.

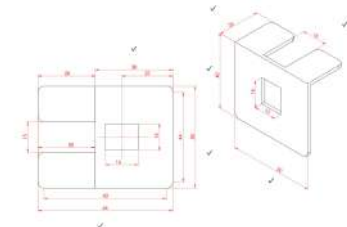
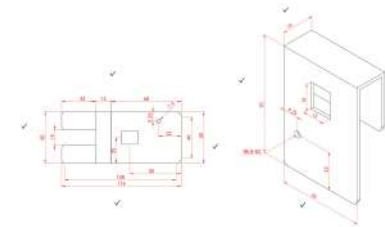
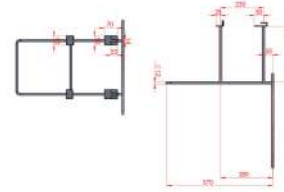
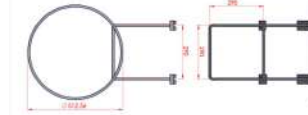

For my Save Thai Ocean project, I designed a watercraft trash net attachment. The device solves the pain point of cruising along the river and craving to clean up floating trash but not having space for the garbage. This might change the perception of river clean-up to something fun! Created using SolidWorks, Circular Cold Saw, Pipe Bender and TIG Welding Machine - Material: SUS 2B Stainless Steel Pipe. 76.2 x 51.3 x 57 cm - Independent project.

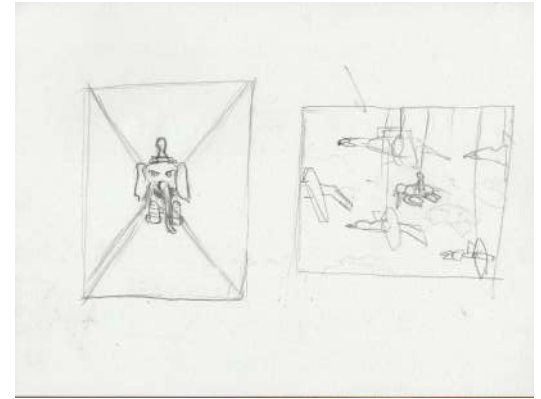
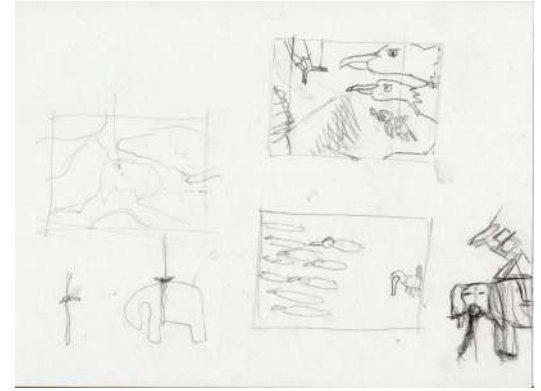

Conceptual Still Life: I am a small-eared Asian elephant among large American bald eagles. As a humongous land animal, I am forced to float just to blend in with the environment but, no matter what, I will still stand out. This oil painting expresses the identical emotions I felt the first day I arrived at boarding school in the United States.

61 x 41 cm - Created using oil paint on canvas - Independent project



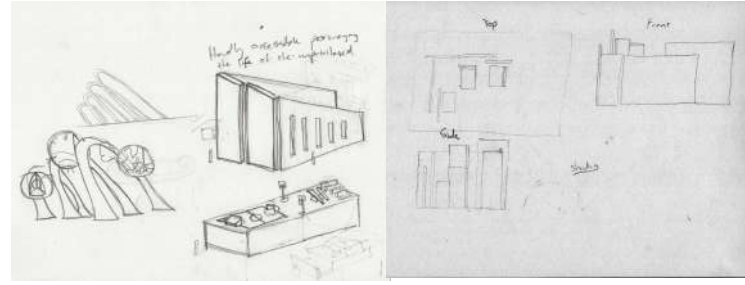
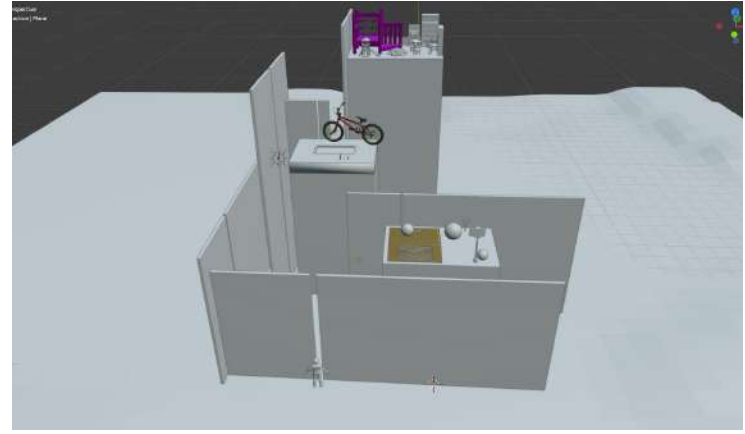

There are a lot of children for whom the concept of the perfect playground stays in their dreams. These architectural playgrounds are captured in a boy's dream. His perception is that it is hard to reach, symbolized through the height of the towers and the fact that every wall contains a narrow vertical slit to peek through but not enter. On the highest floor, there are books, symbolizing that education is furthest out of these children's reach. Created using Blender, pencil and paper - Independent project for StreetChildTalks, picturing the stories heard from Thai street kids.

# Water current measuring device

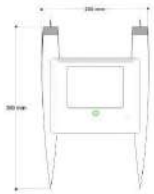

OPTION 1  
IDEA SKETCH  
Water Velocity Meter

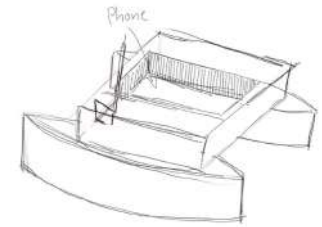
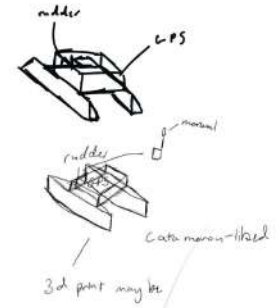
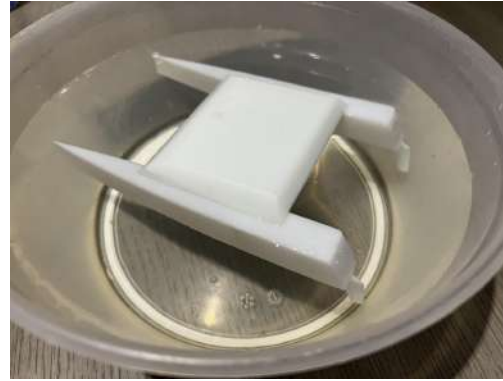
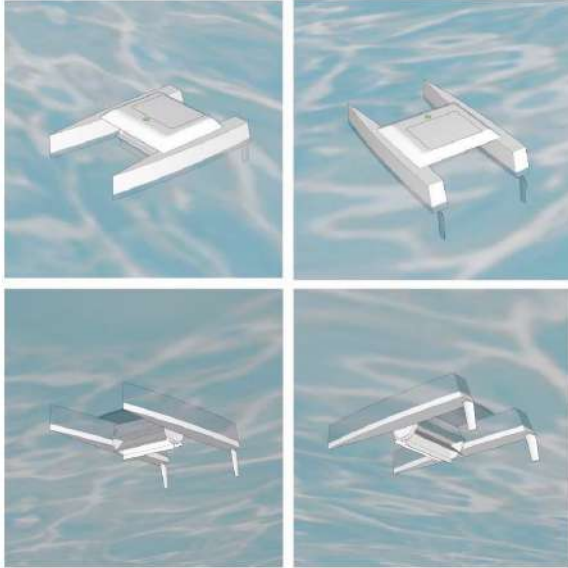

3D-printed portable and affordable water current sensor. It is inspired by a catamaran and my idea is to develop a GPS speedometer to integrate into the body in the next stage. Designed for my Physics teacher, the rowing coach, who wanted a device to measure the current before a race.

Created using SketchUp and an SLA 3D printer

14.5 x 10 x 6 cm - Independent project.

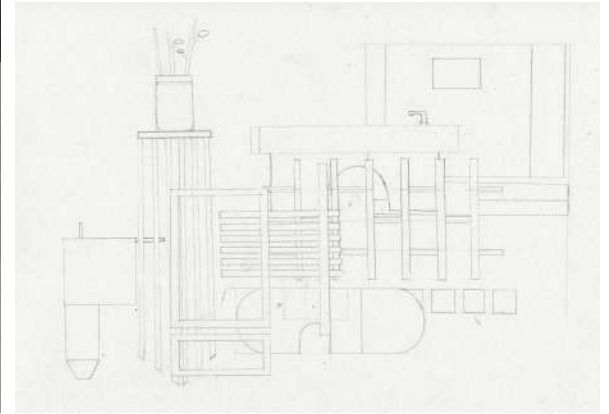
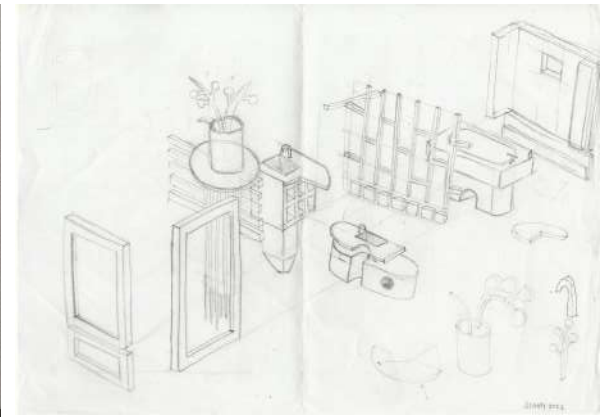
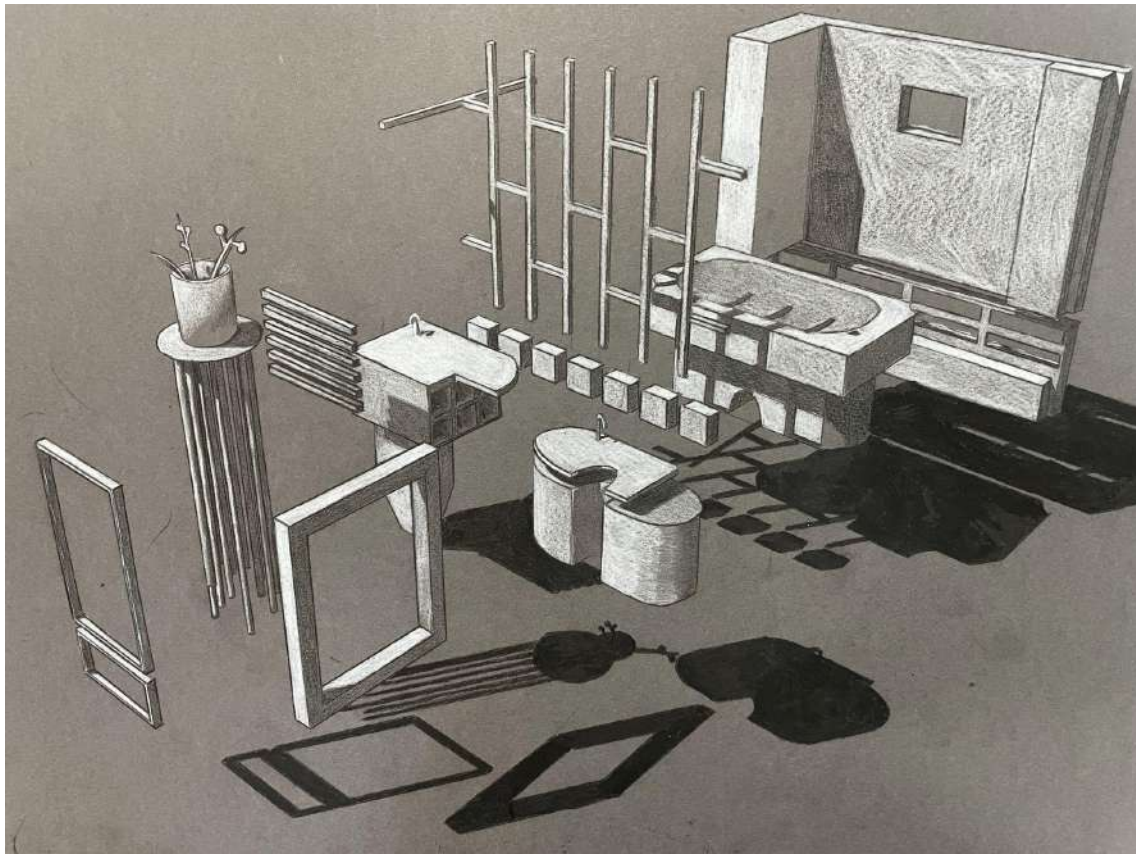

Artwork: Conceptual interior bathroom design inspired by the combination of the various resorts and hotels I have been to in different countries. It expresses the free spirit, open to the surroundings, and at the same time is safe and protected. The shadow is carefully calculated to cast a dramatic effect.

41 x 31 cm - Created using Pigma Micron pens, white color pencil and EE pencil on grey paper - Independent project

# Mask Decontaminator

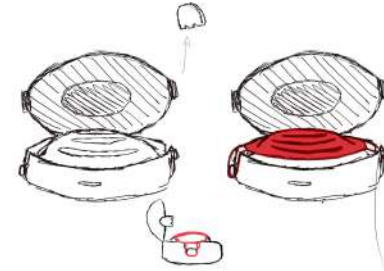
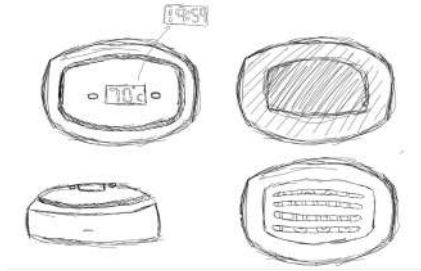

Portable wireless charged mask decontaminator, heats the mask up to 185 degrees Fahrenheit in order to kill any viruses and bacteria. Research from the American Chemical Society supports that this method would allow N95 masks to be reused in up to 50 cycles without damaging the condition of the filtration.

20 x 11 x 4 cm - Created using SketchUp and Procreate - Independent project

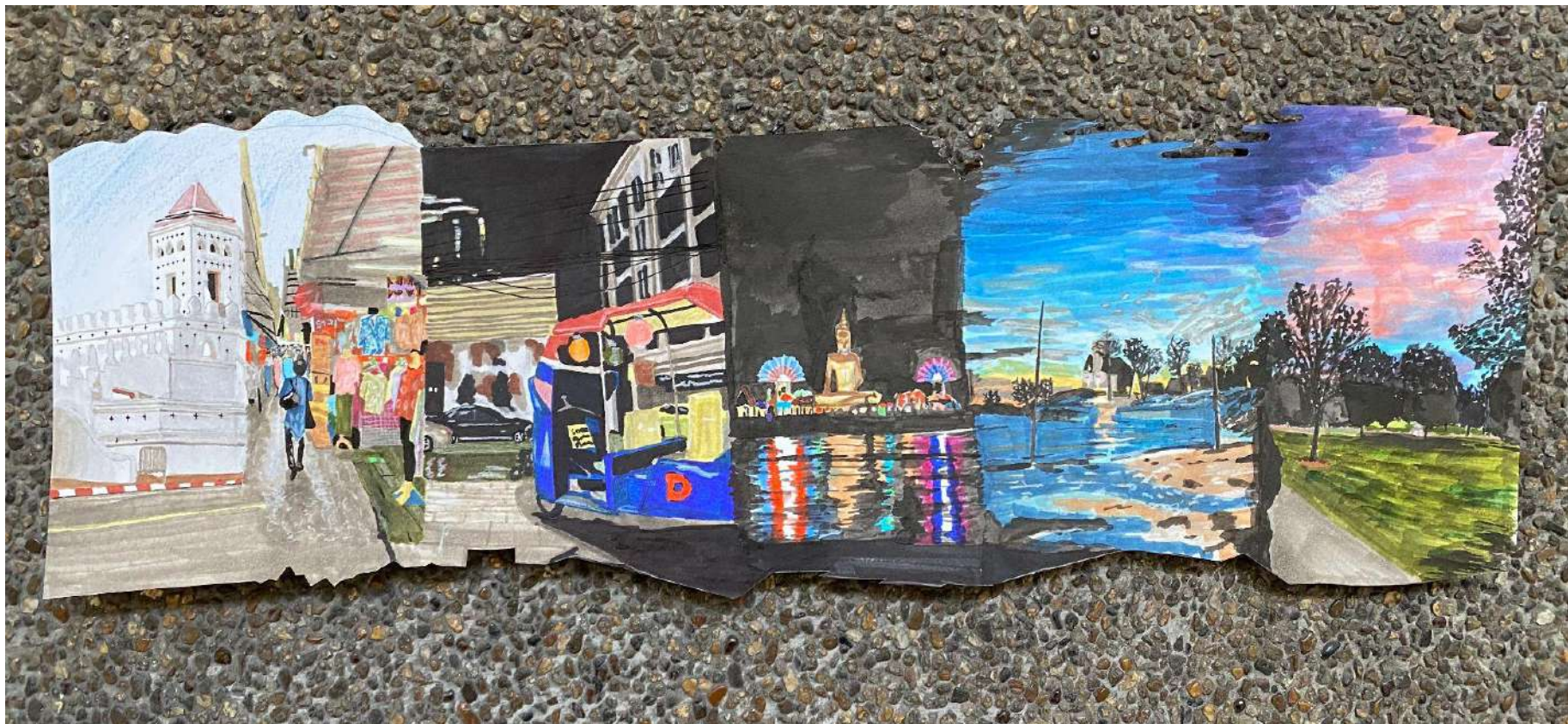

The most memorable places for me from 2021-2022 during the Covid pandemic, portrayed from my own perspective. The four sections, starting on the left, are in Thailand, and the two on the right are at Northfield Mount Hermon, Massachusetts. I blend and carve each section together to show that, no matter the difference between two countries across the world, there will be at least one small way in which they fit into each other.  
56 x 16 cm - Created using Copic markers on paper - Independent project

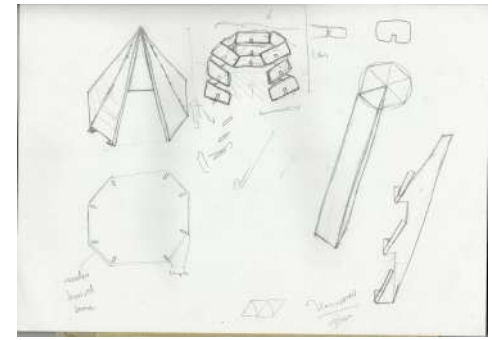
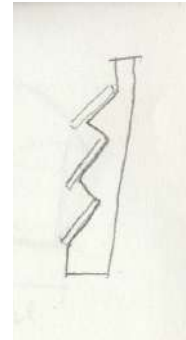
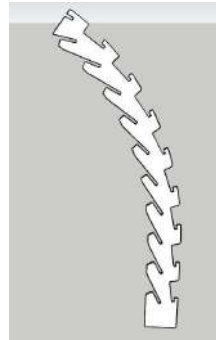
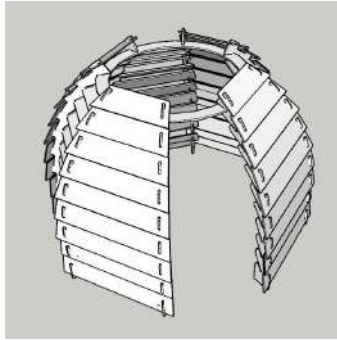
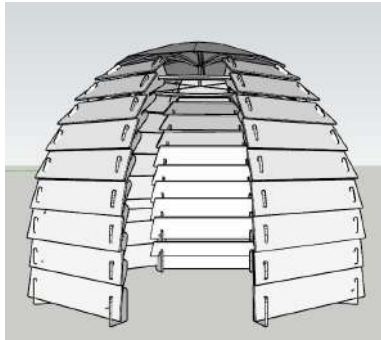
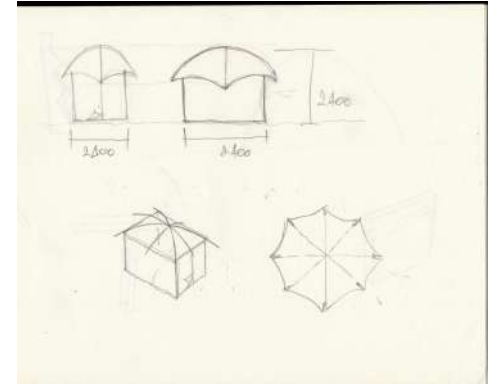
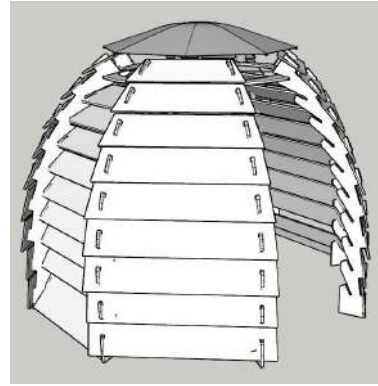
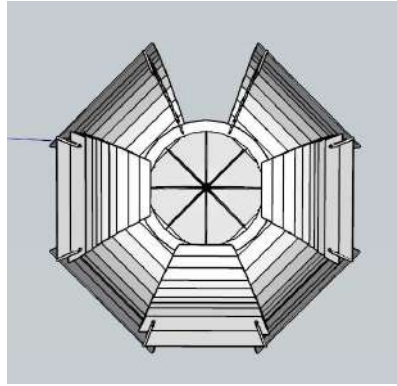
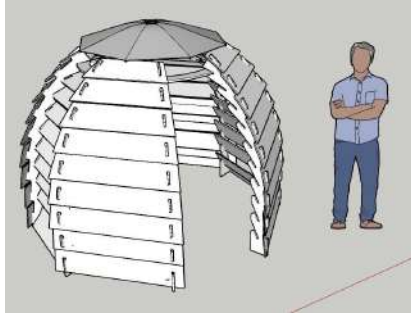

A design for a refugee house that can easily be assembled with interlocking pieces. It is made to tolerate harsh weather conditions, inspired by the shape of an igloo. Because the design consists of multiple identical parts, it would be suitable for mass production in a limited amount of time.  
Created using SketchUp and pencil on paper - Independent project

# PCares: Smart Pacifier

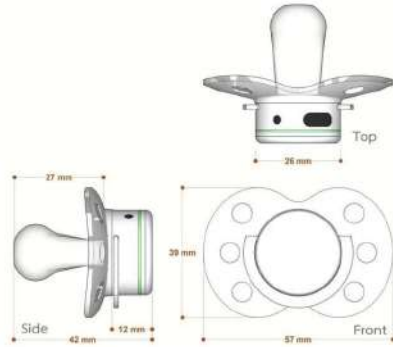
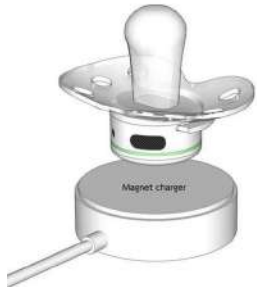
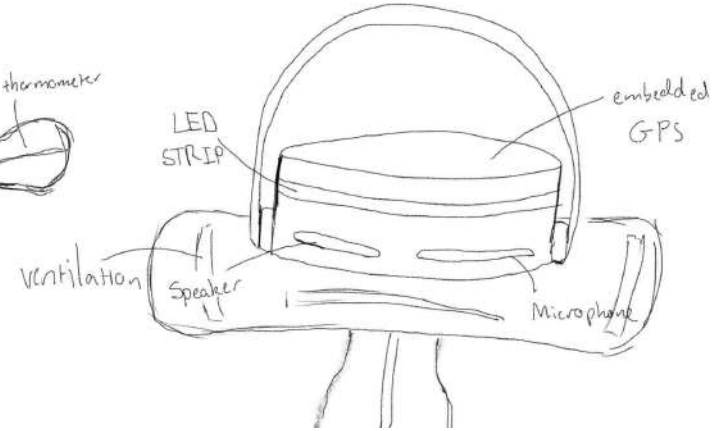
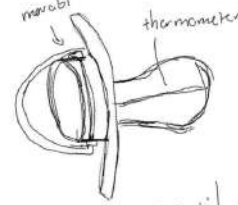
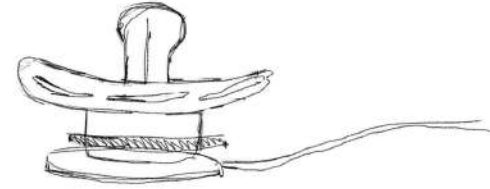
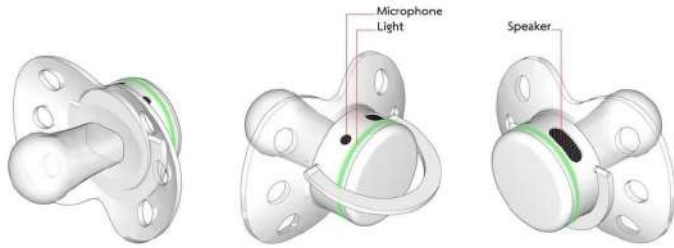

Monitoring Pacifier

Option 1

Conceptual design for a smart pacifier that will allow the parents to monitor the status of their beloved babies. This pacifier is packed with functions, such as a GPS tracker, cry detector, thermometer, and baby monitor. This device had been submitted to the Conrad Challenge.

Designed using SketchUp and Procreate - Independent project

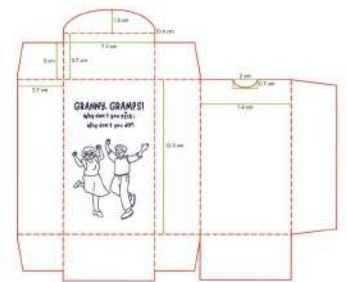

A card game for elderlies. In the past years, I have personally observed significant changes in my grandparents, both physically and cognitively. I decided I want to do something for them, so I created a collection of 30 cards. These allow elderlies to have an activity to look forward to each day, which will help to reduce loneliness and, simultaneously, encourage them to exercise their brains and bodies.

12 x 7 cm per card, the box is 8 x 5 x 14 cm - Created using Procreate and a commercial printing service - Independent project





This piece was a shading exercise to develop my drawing skills, experimenting with different shading techniques. Drawn from a photograph of a small town scene in southern Europe, which I was particularly fascinated by because of how the forms can silently communicate a culture.

Pencil drawing

21 x 30 cm - Independent project.